

# SSR OCRD-D32-A480-10A-ZL

C-DIN Series Solid State Relay 10A, 4 ... 32 VDC



**DIN-rail single-phase solid state relay, DC input voltage DC4~32 V, AC load, load current 10 A.**

The SSR OCRD-D32-A480-10A-ZL is a switching device that uses semiconductor devices instead of contacts. The input and output are optically isolated, and when a control signal is added to the input, the output can be switched from the off state to the on state. Widely used in electric furnace heating and thermostat system, numerical control machinery, plastics machinery, food machinery, packaging machinery, textile machinery, petrochemical instrumentation, entertainment facilities and other automation control fields, suitable for resistive, inductive and capacitive loads. Input control voltage is DC4~32V, output current is 10A, output voltage range is AC24~480V.

## ORDER DETAILS

**Function:** Nominal value inputs: 4 ... 32 V DC, outputs: 24 ... 32 V DC, Output: 24 ... 480 V AC, 14.3mm wide, CE, RoHS

**SKU/Order No.:** SA-SSRC-D032A480-10



## Mechanical Dimensions

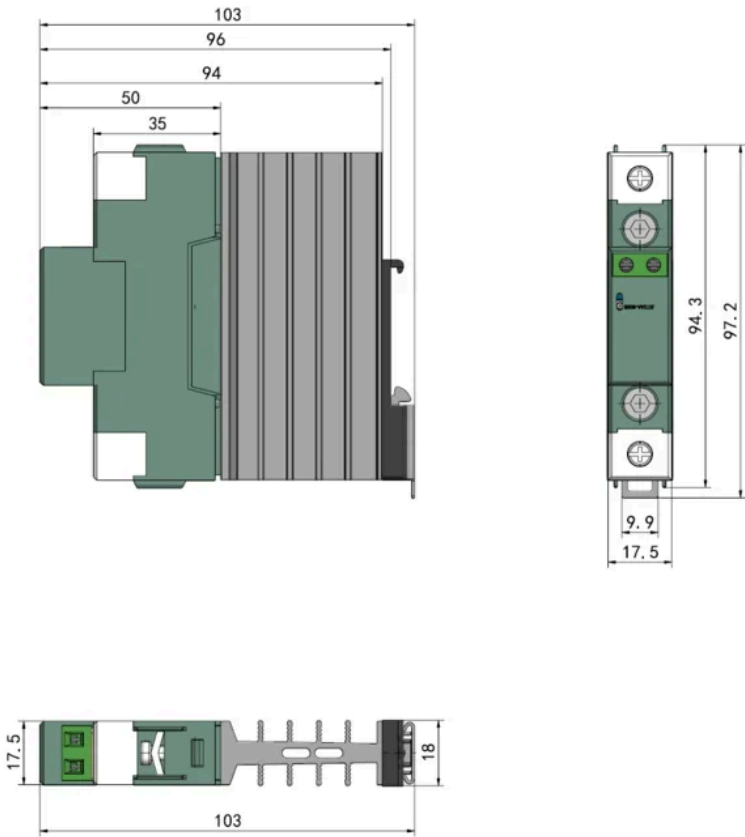

## Drawings

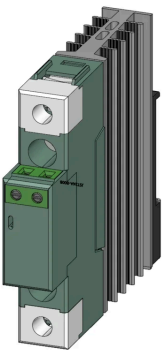

## Technical Data

### Input Data

Input Current (typ.)	12mA
Input Voltage Range DC	4 ~ 32 VDC
Must Operate Voltage	4 VDC
Must Release Voltage	2 VDC

### Output Data

Output Voltage Range	24 ~ 480 VAC
Output Current	10 A
Rated Impulse Withstand Voltage	6 kV

### Ambient Condition

Ambient Temperature (operating)	-30 °C ... 80 °C
Operating Humidity (non-condensing)	45% ... 85% RH
Ambient Temperature (storage/transport)	-30 °C ... 80 °C
Storage Humidity (non-condensing)	45% ... 85% RH

### Certification

Certification	CE
---------------	----

### Characteristics

Insulation resistance	500 M $\Omega$ (500VDC)
Earth Leakage Current	< 1 mA

### Dimensions

Height (mm)	94.3
Width (mm)	18
Depth (mm)	103